

Rugged Door Contact Sensors

- Monitors access with a magnetic bridge sensor (no special inserts necessary).
- Ideal for commercial and industrial installations in harsh environments.
- Heavy-cast metal housing with 3.06-foot armored cable.
- Floor-mounting hardware included.
- For normally open or normally closed circuit connected.
- Wide actuating gap up to 2.5 inches (63 mm).
- Screw terminal.
 - Connect to digital input on an E-2D/5D/16D, E-MINI-LXO, E-MICRO, or E-1W.
- Operating temperature
 - E-DCSR-V2: -67 to 158°F (-55 to 70°C)
 - E-DCSR-UV2: -4 to 140°F (-20 to 60°C).
- Dimensions WxDxH (in):
 - E-DCSR-V2
 - ♦ Magnet: 3.86x1.13x0.52 in (98x29x13 mm)
 - ♦ Switch: 3.5x1.5x0.44 in (89x38x11 mm)
 - E-DCSR-UV2
 - ♦ Magnet: 3.1x1.15x2.14 (79x29x54 mm)
 - ♦ Switch: 3.5x1.5x0.44 (89x38x11 mm)
- Regulatory approvals: UL

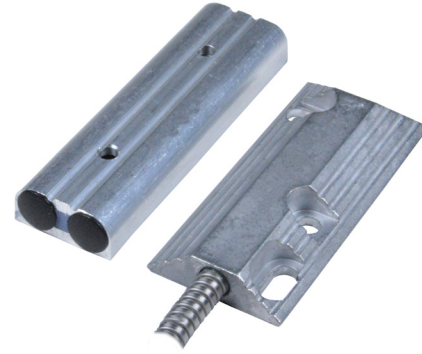

E-DCSR-V2



E-DCSR-UV2

Rugged Door Contact Sensors	
NTI Part #	Description
E-DCSR-V2	Rugged Door Contact Sensor
E-DCSR-UV2	Rugged Door Contact Sensor with Universal Style Magnet